

SUMMARY

Wires

| | |
|---------|----|
| Low | 10 |
| High | 0 |
| Coax | 0 |
| Triax | 0 |
| Quad | 0 |
| Fiber | 0 |
| Fluidic | 0 |

Series 2M

Termination type

IP rating 68

Cable Ø 6.50 - 13.00 mm

Matching parts PHN.2M.310.XLPT

Status

Alternative part



Image is for illustrative purpose only

Download

[Request a quote](#)

[Catalog](#)

TECHNICAL DETAILS

Mechanics

| | |
|-------------------|---|
| Shell Style/Model | FG*: Straight plug with arctic grip and mold stop |
| Keying | 3 keys (beta=165, gamma=30, plug: male contacts, receptacle: female contacts) |
| Housing Material | Environment friendly aluminium (nickel plated, anthracite color) shell and nut, other pieces bronze/brass |
| Cable Fixing | ∅ 6.5 - 13 mm |
| Variant | |

Performance

| | |
|---------------|-------------------------|
| Configuration | 2M.310 : 10 Low Voltage |
| Insulator | |
| Rated Current | 8 Amps |

Specifications

| | |
|--------------------|------------------|
| Contact Type: | Crimp |
| Max. Matings: | 5000 |
| Contact Retention: | 30 N |
| Contact Dia.: | 0.9 mm (0.035in) |
| Bucket Dia.: | 0.8 mm (0.031in) |

Min. Conductor: 0.14 mm² (AWG 26)
 Max. Conductor: 0.34 mm² (AWG 22)
 R (max): 4.8 mOhm
 Test voltage (kV rms) Contact-contact: 1.8
 Test voltage (kV rms) Contact-shell: 1.2

Others

Humidity (max): <=95% [at 60 deg C / 140 F]
 Vibration: 15 g [10 Hz - 2000 Hz]
 Shock Resistance: 100 g [6 ms]
 Operating temperature: -55° C/ +200° C
 Climatical Category: 15/200/21 (Al. shell)
 Lighting strike EIA 364-75 10K amps - 6 times
 EMI Shielding EIA 364-66A - 1Ghz-80 dB,3GHz-70 dB,6GHz- 58dB
 IP Rating: 68

DRAWINGS

Draws

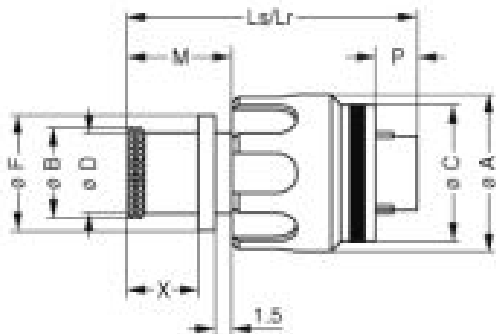

Dimensions

| | A | B | C | D | F | Lr | Ls | M | P | X |
|-----|------|------|------|------|------|------|------|------|------|------|
| mm. | 18.9 | 14 | 17.2 | 13 | 15.5 | 27.5 | 27.5 | 10.1 | 3.9 | 7.1 |
| in. | 0,74 | 0,55 | 0,68 | 0,51 | 0,61 | 1,08 | 1,08 | 0,40 | 0,15 | 0,28 |









RECOMMENDED BY LEMO

Tools

Crimp Tool: DPC.91.701.V
 Crimp settings: AWG/Selector = 22-24-26/5-4-4

Positionner: DCE.91.090.5MVC
 Extractor: DCF.93.090.4LT
 Replacement contact: FGN.0M.561.ZZCT

Cables

| | | | |
|--------------------|---------------|-------|---|
| CMN.10.T22.068PGCE | PVC | GREY |  |
| CMN.10.T22.068PGZE | | Grey |  |
| CMN.10.T22.068PNCE | PVC | Black |  |
| CMN.10.T22.068PNZE | | |  |
| CMN.10.T22.068QGZE | TPR (medical) | Grey |  |
| 110 220 | PVC | Black |  |
| 210 240 | PVC | Black |  |
| 210 250 | PVC | Grey |  |