



DESCRIPTION: CAT5E, RJ45 (8P8C) MODULAR PLUG, UNSHIELDED, OFF-SET ,SOLID/STRANDED, ROUND CABLE

MODEL NUMBER: 32-2198UL

APPLICATION: MODULAR PLUG

CRIMP TOOL: N/A

IMPEDANCE: N/A

FREQUENCY RANGE: N/A

MATERIAL: HOUSING CLEAR POLYCARBONATE UL94-V0  
CONTACT PHOSPHOR BRONZE  
SELECTIVE GOLD PLATING  
MANAGEMENT BAR CLEAR POLYCARBONATE UL94-V0

RoHS COMPLIANCE: YES

TECHINCAL DETAIL: N/A

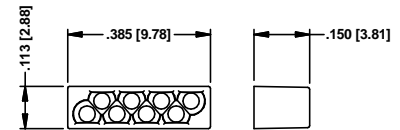
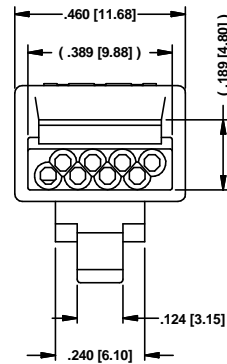
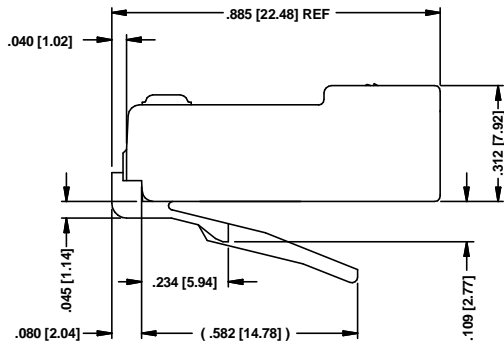
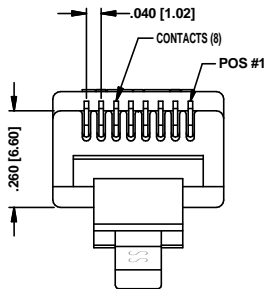
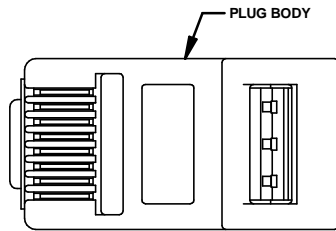

MANAGEMENT BAR

<p>This PROPRIETARY Document is property of Cinch Connectivity Solutions. It is confidential in nature, non-transferable, and issued with the clear understanding that it is not traded or copied without permission and is returnable upon demand.</p> <p>INTERPRET DRAWING IN ACCORDANCE WITH ASME Y14.5-2009.</p>	<p>3RD ANGLE PROJECTION</p>	<h2>AIM-Cambridge</h2>	
	<p>RoHS2 <input checked="" type="checkbox"/></p> <p>2011/65/EU</p>	<p>Title: CAT5E, RJ45 (8P8C) Modular Plug, Unshielded Off-set ,Solid/Stranded, Round Cable</p>	
	<p>UNLESS OTHERWISE SPECIFIED</p> <p>.XX ±.02</p> <p>.XXX ±.005</p> <p>ANGLES ±2°</p>	<p>Model No. 32-2198UL</p>	
	<p>Size A</p>	<p>DO NOT SCALE DRAWING</p>	<p>Date: 2015/5/19</p>