

## SUMMARY



*Image is for illustrative purpose only*

### # Wires

Low	22
High	0
Coax	0
Triax	0
Quad	0
Fiber	0
Fluidic	0

### Download

[Request a quote](#)

[Catalog](#)

Series	3F
Termination type	Female crimp
IP rating	67
Cable Ø	5.30 - 16.00 mm
Matching parts	FGN.3F.322.XLC
Status	
Alternative part	

## TECHNICAL DETAILS

### Mechanics

Shell Style/Model	PE*: Straight receptacle, nut fixing (back panel mounting)
Keying	3 keys (beta=150, gamma=60, plug: male contacts, receptacle: female contacts)
Housing Material	Environment friendly aluminium (nickel plated, anthracite color) shell and nut, other pieces bronze/brass
Cable Fixing	∅ 5.3 - 16 mm
Variant	

### Performance

Configuration	3F.322 : 22 Low Voltage
Insulator	L: PEEK (UL 94 / V-0/3.2, depends on material thickness)
Rated Current	5.5 Amps

### Specifications

Contact Type: Crimp
Max. Matings: 5000
Contact Retention: 22 N
Contact Dia.: 0.7 mm (0.028in)
Bucket Dia.: 0.8 mm (0.031in)

Min. Conductor: 0.14 mm<sup>2</sup> (AWG 26)  
 Max. Conductor: 0.34 mm<sup>2</sup> (AWG 22)  
 R (max): 6.1 mOhm  
 Vtest (contact-shell): 1450 V (AC), 2050 V (DC)  
 Vtest (contact-contact): 1700 V (AC), 2400 V (DC)

## Others

Endurance (Shell): 1000 mating cycles  
 Temp (min / max): -15°C / +200°C  
 Humidity (max): ≤95% [at 60 deg C / 140 F]  
 Vibration: 15 g [10 Hz - 2000 Hz]  
 Shock Resistance: 100 g [ 6 ms]  
 Climatological Category: 15/200/21 (Aluminium shell)  
 IP Rating: 67

## DRAWINGS

### Draws

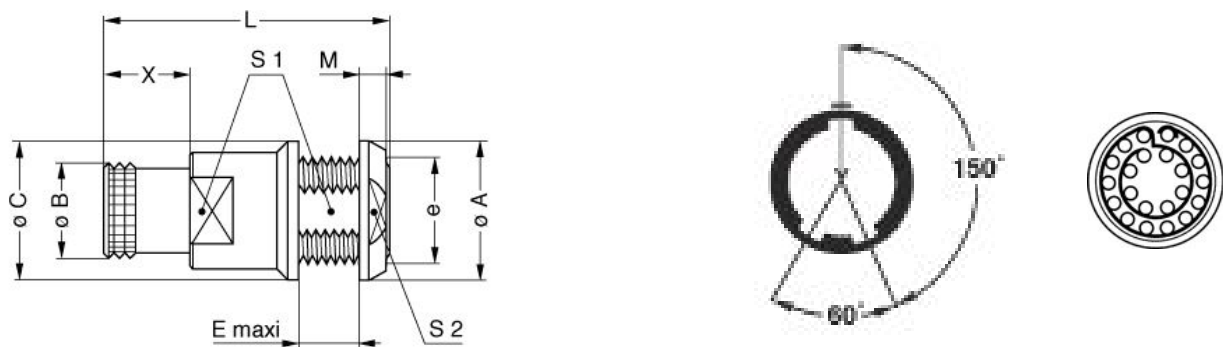

### Dimensions

	A	B	C	E	L	M	S1	S2	e
mm.	22	16	22	6.4	28.2	4	16.5	19	M18x1.0
in.	0,87	0,63	0,87	0,25	1,11	0,16	0,65	0,75	

## RECOMMENDED BY LEMO

### Tools

Crimp Tool: DPC.91.701.V  
 Positionner: DCE.91.070.BVM  
 Extractor: DCF.93.070.4LT

## Cables

CMN.22.T22.088PGCE	PVC	GREY	
CMN.22.T22.088PGZE		Grey	
CMN.22.T22.088PNCE	PVC	Black	
CMN.22.T22.088PNZE			
CMN.22.T30.054QGZE	TPR (medical)	Grey	