

THIS DRAWING IS UNPUBLISHED. RELEASED FOR PUBLICATION
 © COPYRIGHT - By - ALL RIGHTS RESERVED.

REVISIONS				DATE	DWN	APVD
LOC	DIST	P	LTR	DESCRIPTION		
-	-			REV PER ECO-15-002995	11MAR15	KG PD

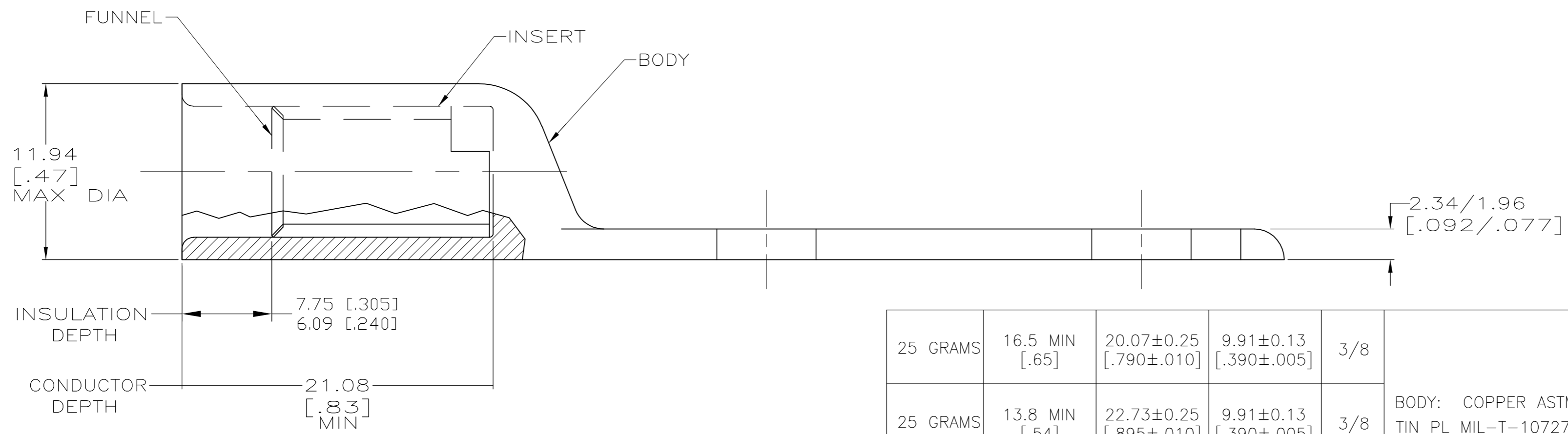
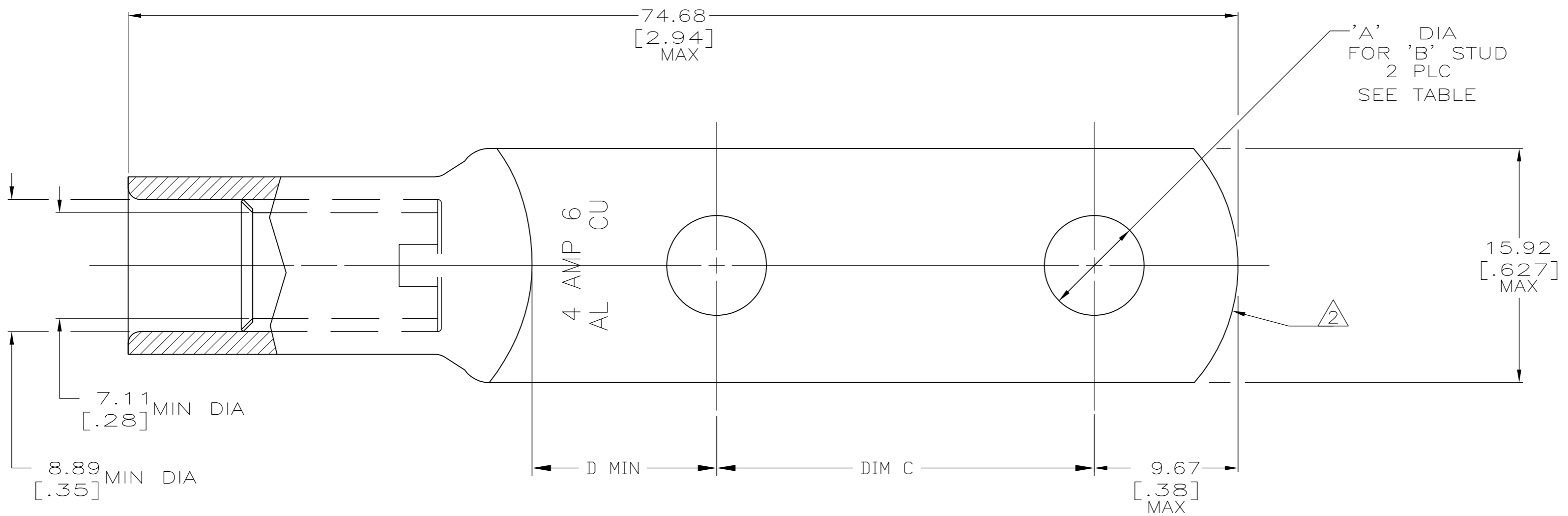

1 WIRE INSULATION: 7.01[.276] - 7.75[.305] DIA
 2 THE TONGUE RADIUS FEATURE IS NOT A TOOLING CONTROLLED DIMENSION AND MAY NOT BE A TRUE RADIUS.

WEIGHT	"D"	"C"	"A"	"B"	MATERIAL AND FINISH	PART NO.
25 GRAMS	16.5 MIN [.65]	20.07±0.25 [.790±.010]	9.91±0.13 [.390±.005]	3/8	BODY: COPPER ASTM-B187 ANNEALED TIN PL MIL-T-10727 0.00457[.000150] MIN THK INSERT & FUNNEL: BRASS PER ASTM B36 NICKEL PLATE SAE AMS QQ-N-290A, DATED JULY 2000, 0.00254 [.000100] MIN THK	55833-4
25 GRAMS	13.8 MIN [.54]	22.73±0.25 [.895±.010]	9.91±0.13 [.390±.005]	3/8		55833-3
25 GRAMS	11.18 MIN [.440]	25.40±0.25 [1.000±.010]	9.91±0.13 [.390±.005]	3/8		55833-2
26 GRAMS	11.18 MIN [.440]	25.40±0.25 [1.000±.010]	6.73±0.08 [.265±.003]	1/4		55833-1

THIS DRAWING IS A CONTROLLED DOCUMENT.

DWN DK SCHRUM 6/15/92	 TE Connectivity
CHK WJ VOCKROTH 6/16/92	
APVD AJ KAUFMAN 6/16/92	
NAME	
DIMENSIONS: INCHES	PRODUCT SPEC 108-11011
TOLERANCES UNLESS OTHERWISE SPECIFIED:	APPLICATION SPEC 114-2134
0 PLC ± -	SIZE A2
1 PLC ± -	CAGE CODE 00779
2 PLC ± -	DRAWING NO C=55833
3 PLC ± -	RESTRICTED TO -
4 PLC ± -	
ANGLES ± -	
MATERIAL SEE TABLE	FINISH SEE TABLE
WEIGHT SEE TABLE	SCALE 4:1
CUSTOMER DRAWING	SHEET 1 OF 1
	REV K