

X  
Kontaktanordnung  
contact arrangement

160 Signal Kontakte  
160 signal contacts

☒ = Kontaktposition belegt  
= position with contact

☐ = Kontaktposition nicht belegt  
= position without contact

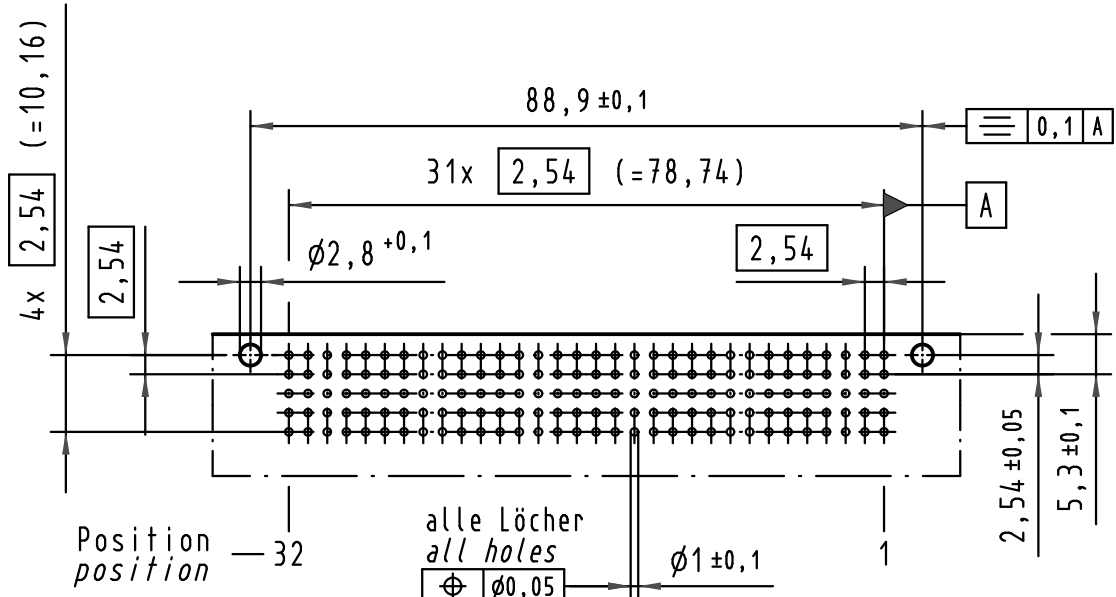

Y (Lochbild)  
(board drillings)

Reihe  
row

z  
a  
b  
c  
d

Position  
position

alle Löcher  
all holes

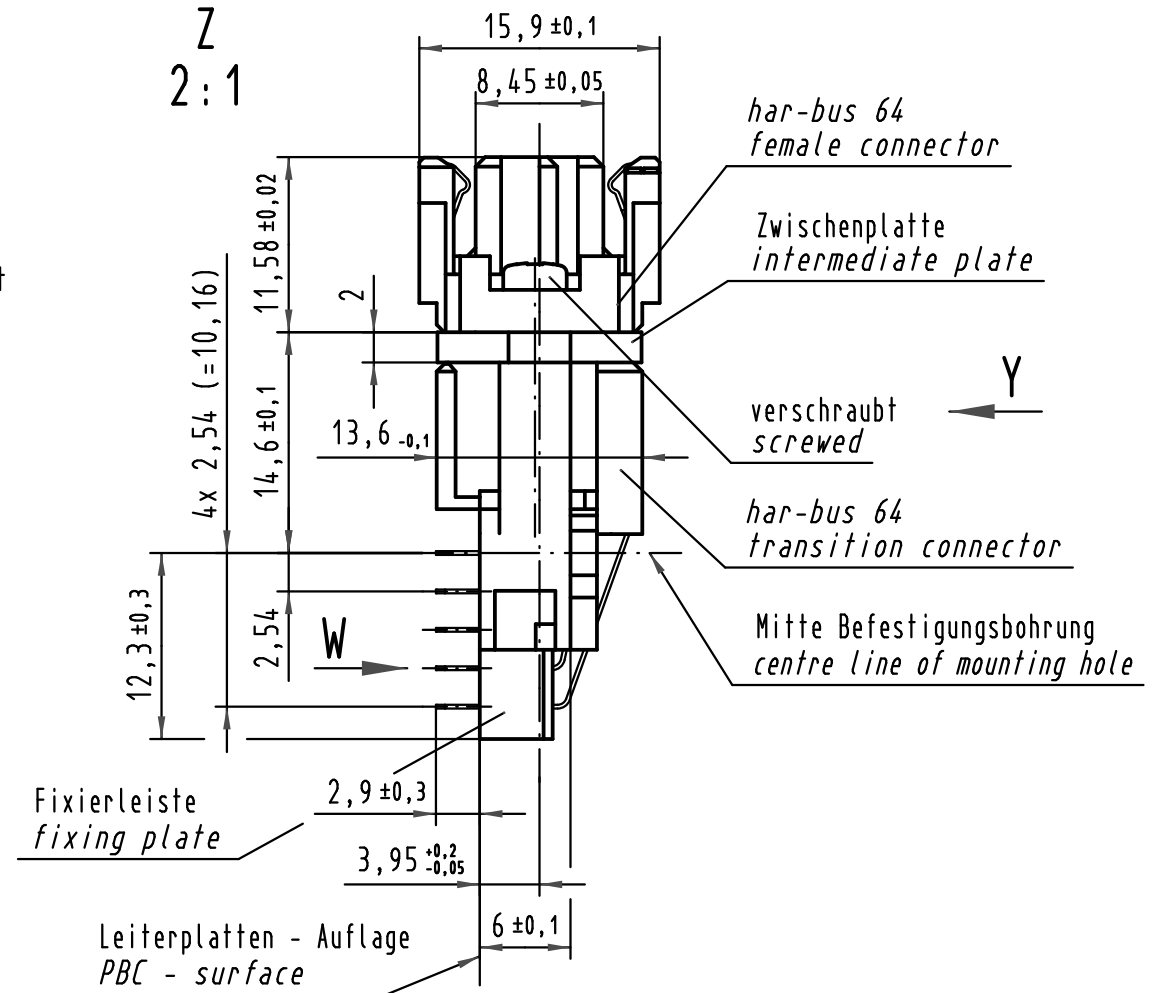
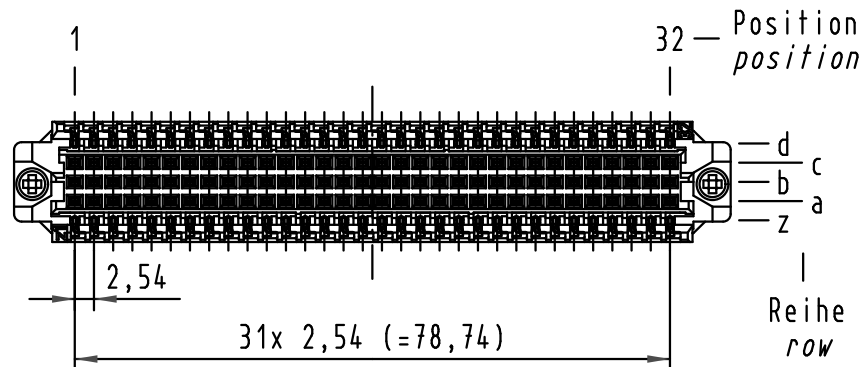
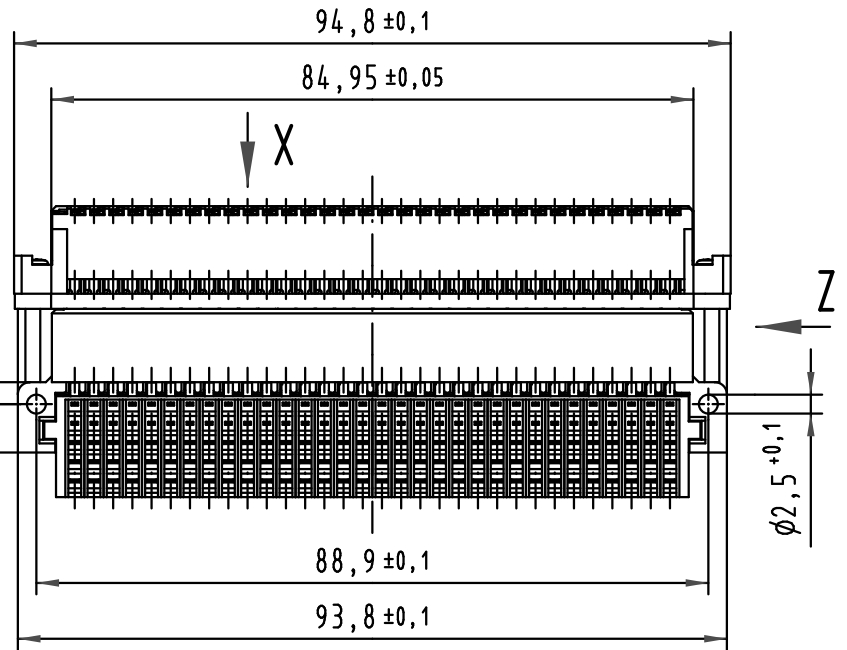

W Querschnitt der Lötanschlüsse:  
cross-section of solder terminations:

Reihe / row z, a

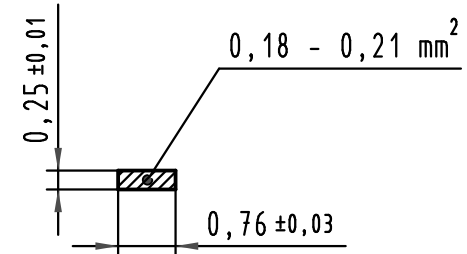

Reihe / row b, c, d

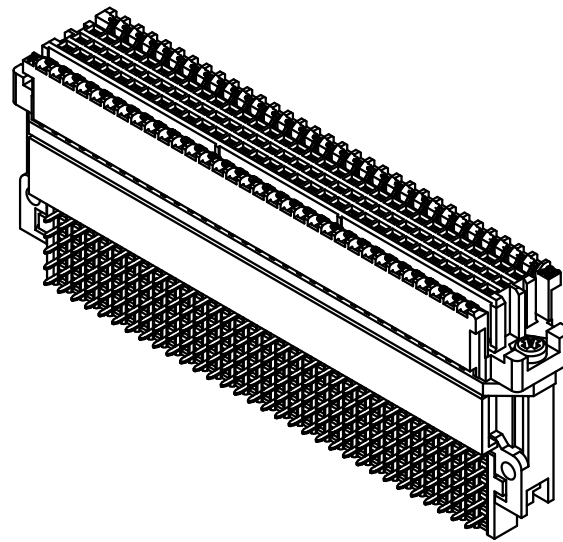
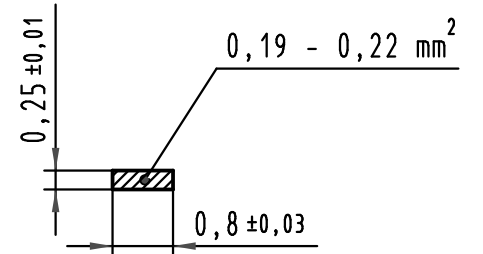

02 07 160 1101	1	Au über/over Ni
Bestell-Nr. part-no.	Anforderungsstufe nach IEC performance level acc. to IEC	Kontaktfläche contact plating

All Dimensions in mm Original Size DIN A 3			Techn. Character.			Nicht tolerierte Maß/Free size tolerances ergänzend/complementary IEC 61076-4-113		
			Dat.	Name	Maßstab/Scale	<b>har-bus 64</b> Extender Card Connector Einlöt 160 pol. extender card connector solder 160 pol.		
			Detail.	13.10.05 Leh.	1:1			
			Insp.	13.10.05 kfoe	2:1			
			Stand.		10:1			
35956	03.12.09	Hage.				<b>TB 02 07 160 x101</b> Blatt/page		
33723	19.07.06	LehT						
32907								
Mod.	Dat.	Name	HARTING Electronics GmbH & Co. KG D-32339 ESPELKAMP			Sub. 02 07 160 x101 Mod. 31468 v. 10.07.03		