

THIS DRAWING IS UNPUBLISHED. RELEASED FOR PUBLICATION
 © COPYRIGHT 19 BY AMP INCORPORATED. ALL RIGHTS RESERVED.

Loc		Dist		REVISIONS			
P	LTR	DESCRIPTION	DATE	DWN	APVD		
0		RELEASED PER 0600-7709-98	8-98	CT	RG		

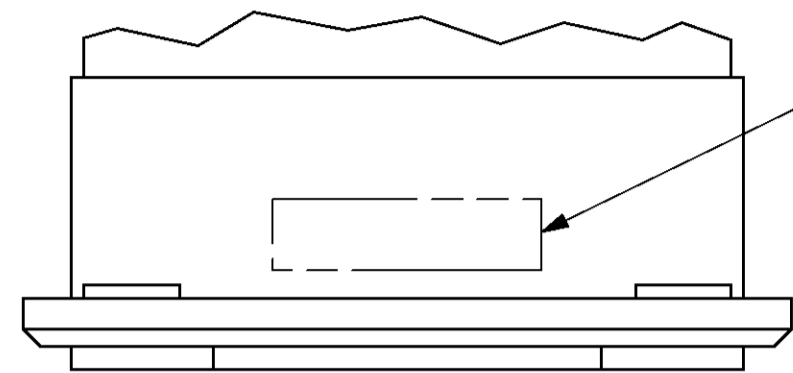

AMP PART NUMBER
MARKED IN THIS AREA

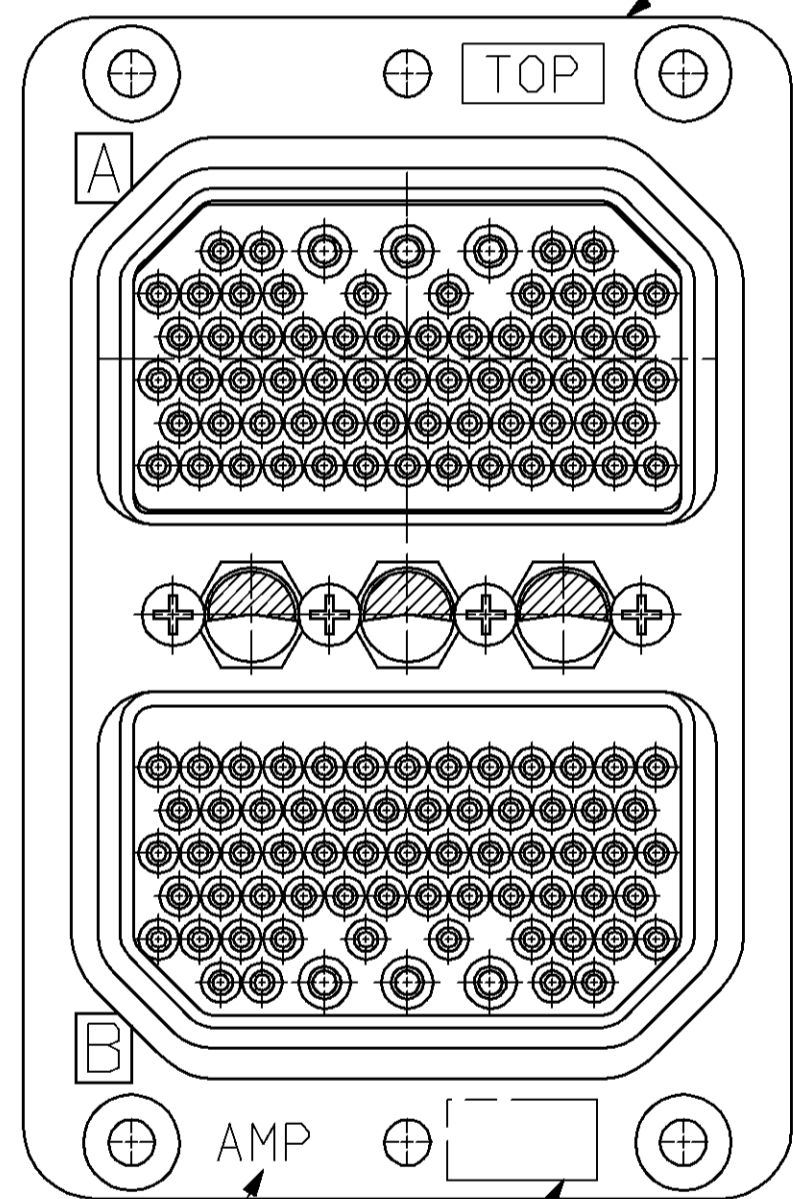

RECEPTACLE SHELL
 MATERIAL: ALUMINUM PER QQ-A-591
 FINISH: CADMIUM PLATED PER QQ-P-416
 COLOR: YELLOW CHROMATE

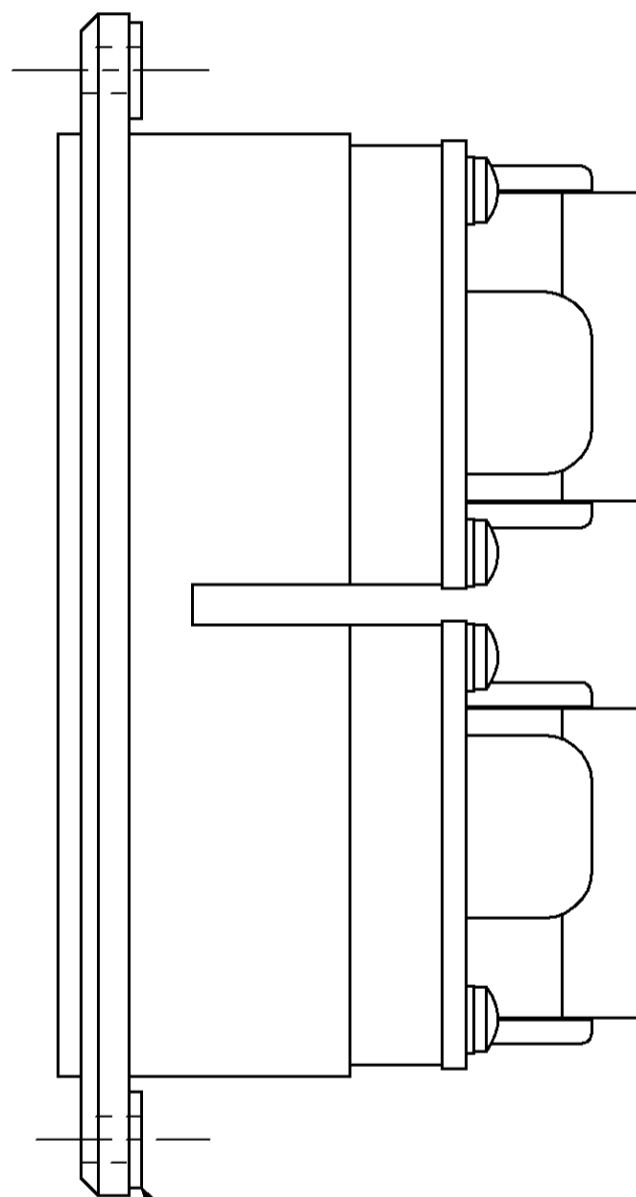

FLOAT BUSHINGS
4 PLC

RETAINER PLATE (2 PLC)
 MATERIAL: ALUMINUM
 PER QQ-A-250/8
 FINISH: BLUE ANODIZED
 PER MIL-A-8625

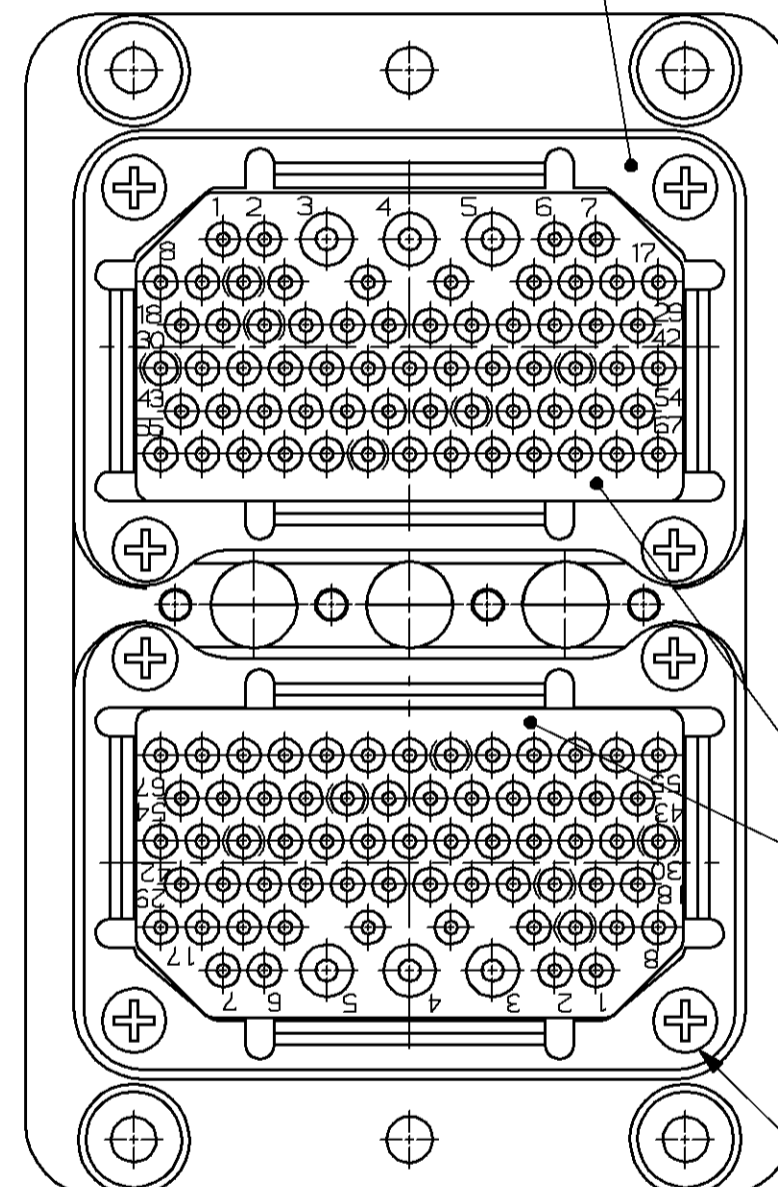

INSERT ASSY, 67P
 MATERIAL: EPOXY
 COLOR: BLACK

SCREW & LOCKWASHER (QTY=8)
 MATERIAL: STAINLESS STEEL
 PER QQ-S-766
 FINISH: PASSIVATED
 PER QQ-P-358

AMP MARKED
IN THIS AREA

DATE CODE MARKED
IN THIS AREA

- KEYING IS SET IN POSITION "01".
- CONNECTOR IS SUPPLIED WITHOUT CONTACTS.

1218343-1
PART NO.

THIS DRAWING IS A CONTROLLED DOCUMENT.		DWN C.C.THOMAS 8-18-98	AMP Incorporated Harrisburg, PA 17105-3608															
DIMENSIONS: INCHES [mm]		CHK D.BELL 8-18-98	NAME ASSEMBLY, ARINC 404 RECEPTACLE RME2R67P67P-3301 (201)															
TOLERANCES UNLESS OTHERWISE SPECIFIED:		APVD D.BELL 8-18-98																
<table border="1"> <tr><td>0 PLC</td><td>±-</td></tr> <tr><td>1 PLC</td><td>±-</td></tr> <tr><td>2 PLC</td><td>±-</td></tr> <tr><td>3 PLC</td><td>±-</td></tr> <tr><td>4 PLC</td><td>±-</td></tr> <tr><td>ANGLES</td><td>±-</td></tr> <tr><td>FINISH</td><td>-</td></tr> </table>		0 PLC	±-	1 PLC	±-	2 PLC	±-	3 PLC	±-	4 PLC	±-	ANGLES	±-	FINISH	-	PRODUCT SPEC -	SIZE A2	CAGE CODE 00779
0 PLC	±-																	
1 PLC	±-																	
2 PLC	±-																	
3 PLC	±-																	
4 PLC	±-																	
ANGLES	±-																	
FINISH	-																	
MATERIAL -		APPLICATION SPEC -	DRAWING NO 1218343	RESTRICTED TO -														
		WEIGHT -	SCALE 2:1	SHEET 1 OF 1														
		CUSTOMER DRAWING	REV 0															